



# Russell Hobbs

A BRITISH ICON SINCE 1952

## RHCBLDL3IN1B-AU Operating Manual

[russellhobbs.com.au](http://russellhobbs.com.au)  
[russellhobbs.co.nz](http://russellhobbs.co.nz)

## CONTENTS

Safety Instructions	3
Battery Warnings	8
Product Overview	10
Product Setup	11
Controls and Display	12
Remote Control	15
Cleaning and Maintenance	17
Problem Solving	18
Customer Service and Warranty	21
Warranty Conditions	22



Read this guide carefully before installing or operating your new appliance and keep it somewhere safe for future reference.

## SAFETY INSTRUCTIONS

- It is hazardous for anyone other than a qualified electrician to carry out any service or repair operation that involves the removal of a cover which gives protection against exposure to electrical parts.
- Do not use with a damaged cord or plug. If the supply cord is damaged, it must be replaced by the manufacturer, its service agent, or similarly qualified technicians to avoid a hazard.
- This product is intended for household use only.
- Do not use outdoors.
- Cleaning and user maintenance should not be made by children without supervision.
- Children should be supervised to ensure that they do not play with the appliance.
- This appliance is not intended for use by persons (including children) with reduced physical, sensory or mental capabilities, or lack of experience and knowledge, unless they have been given supervision or instruction concerning use of the appliance by a person responsible for their safety.
- Do not operate this appliance for anything other than its intended use.
- Do not immerse whole unit in water or other liquids for cleaning.
- Unplug from outlet when not in use. Do not leave unattended while plugged in.
- Do not use if there are visible signs of damage to the appliance.
- Do not use if it has been dropped, damaged, left outdoors or submerged in water.
- Keep the appliance away from water. Do not allow it to get wet. If the unit gets wet, do not plug the unit into a wall socket or turn the unit on.

## SAFETY INSTRUCTIONS

- Do not handle the appliance with wet hands.
- Do not pull or carry by the cord, use the cord as a handle, close doors on the cord, pull the cord around sharp corners or edges, or expose the cord to heated surfaces. Do not unplug by pulling on the cord.
- To protect against electrical shock, do not immerse the cord, plug, or appliance in water or other liquids.
- Unplug from the mains outlet when not in use, before putting on and taking off parts, and before cleaning.
- Only use the unit when fully assembled.
- Never place your fingers or other objects into any part of the appliance. Be aware that loose clothing or hair may become trapped in the appliance if improperly used.
- Before use, ensure that all the air vents of the appliance are clear and there is no restriction of air flow.
- Caution: Appliance may disturb ashes in an open fire. Always avoid directing the appliance toward naked flames.
- Do not remove the rotor guard once assembled.
- The appliance must not be left unattended while it is connected to the mains supply.
- Do not touch hot surfaces. Use the handle or the controls.
- Ensure appliance is on a flat, stable, heat-resistant surface.

## SAFETY INSTRUCTIONS

- Do not let the cord hang over the edge of a worktop, table etc. or touch hot surfaces.
- The use of accessory attachments not recommended by the appliance manufacturer may cause fire, electric shock or injury.
- Never remove parts from the appliance, such as the feet and screws etc.
- Do not use the appliance near a bath, shower or a swimming pool.
- Never place flammable objects or clothing on top of the appliance.
- Allow a 100cm safe area around the appliance on the top and sides and a 150cm safe area at the front.
- Never use the appliance in a room with explosive gases such as petrol, or while using any kinds of flammable glues, sprays or solvents.
- Prevent overheating of the appliance by keeping the air inlets and outlets clean and free of anything that may cause blockages. Check all inlets and outlets regularly for accumulated dust.
- DO NOT COVER.
- Do not place any part of your body near the air inlet, outlet, or on the fins to avoid personal injury, electric shock or fire.
- If overheating should occur, the built-in overheating safety device will shut the appliance off.
- Caution: Some parts of this product can become very hot and cause burns. Particular attention must be given when children or vulnerable people are present.

## SAFETY INSTRUCTIONS

- Do not insert any foreign objects into the grill.
- Keep all grills clear of any draped fabric or curtains.
- The appliance must not be located immediately below a mains outlet. Do not use the appliance with a programmer, timer or any other device that switches the appliance on automatically. A fire risk exists if the appliance is covered or positioned incorrectly.
- Use this heater on a horizontal and stable surface, or fix it to the wall, as applicable.
- **WARNING:** Do not use this heater in small rooms occupied by individuals who require assistance to exit the room on their own, unless they are under constant supervision.
- **WARNING:** To reduce the risk of fire, keep textiles, curtains, or any other flammable material a minimum distance of 1m from the air outlet.
- **WARNING:** To avoid overheating or fire, do not cover the heater.

### **Electrical Safety**

- Before switching on, make sure that the voltage of your electricity supply is the same as that indicated on the rating plate.
- This product is designed to operate on 220 - 240V~, 50-60Hz. Connection to any other power source may damage the unit.
- For added safety, electrical appliances should be connected to a power outlet that is protected by a residual current device (RCD/‘Safety Switch’) having a rated residual operating current not exceeding 30mA. Your switchboard may already incorporate an RCD. If unsure, call an electrician for verification and fitting if necessary.

### **WARNING: THE APPLIANCE AND REMOTE CONTROL BOTH CONTAIN MAGNETS.**

- Pacemakers and defibrillators may be affected by strong magnetic fields. If you or someone in your household has a pacemaker or defibrillator, avoid placing the remote control in a pocket or near the device.
- Credit cards and electronic storage media may also be affected by magnets and should be kept away from the remote control and the appliance.



This symbol means “DO NOT COVER”

## BATTERY WARNINGS

### WARNING:

This product contains a button/coin battery and is hazardous. Keep batteries away from children (whether the battery is new or used). Batteries can cause severe or fatal injuries in 2 hours or less if swallowed or placed inside any part of the body. Seek medical attention immediately if it suspected the battery has been swallowed or placed inside any part of the body.

- **INGESTION HAZARD:** This product contains a button cell or coin battery
- **DEATH** or serious injury can occur if ingested.
- A swallowed button cell or coin battery can cause **INTERNAL CHEMICAL BURNS** in as little as **2 hours**.
- **KEEP** new and used batteries **OUT OF REACH OF CHILDREN**.
- **Seek immediate medical attention** if a battery is suspected to be swallowed or inserted inside any part of the body.
- For fast, expert advice, contact 24-hour: Australian Poisons Information Centre on **13 11 26** or New Zealand National Poisons Information Centre on **0800 764 766**



- This appliance comes with a CR2025 battery which is fitted into the remote. Remove the insulation sheet before use.
- There is risk of chemical burns. Always wear protective gloves when handling.
- Chemicals escaping from a battery can cause skin irritation.
- In case of contact with skin, rinse with thoroughly with water. In case of contact with eyes, do not rub your eye, but rinse it with water and immediately consult a doctor.
- Do not try to recharge batteries. Recharging is only allowed for batteries which are marked as “rechargeable”. There is a danger of explosion.



## BATTERY WARNINGS

- Regularly check the batteries. Leaking chemicals can cause heavy damage to the device. Dealing with damaged or leaking batteries, exercise a particular caution.
- When inserting the battery, pay special attention to the correct polarity. Wrong polarity can cause risk of bursting.
- Remove the batteries from the unit if you are not going to use it for a long time or if you want to store it.
- Do not allow children to replace batteries.
- Always choose the right size and the right battery type for the intended use.
- Clean the battery contacts and equipment contacts before installing the batteries.
- Remove used-up batteries immediately.
- Do not dismantle the batteries.
- If the battery compartment does not close securely, do not use the remote control anymore and keep it away from children.
- Please avoid extreme conditions and temperatures which can adversely affect the batteries/rechargeable batteries( e.g., placing them on radiators/direct solar radiation).
- The connection terminals must not be short-circuited.

# PRODUCT OVERVIEW

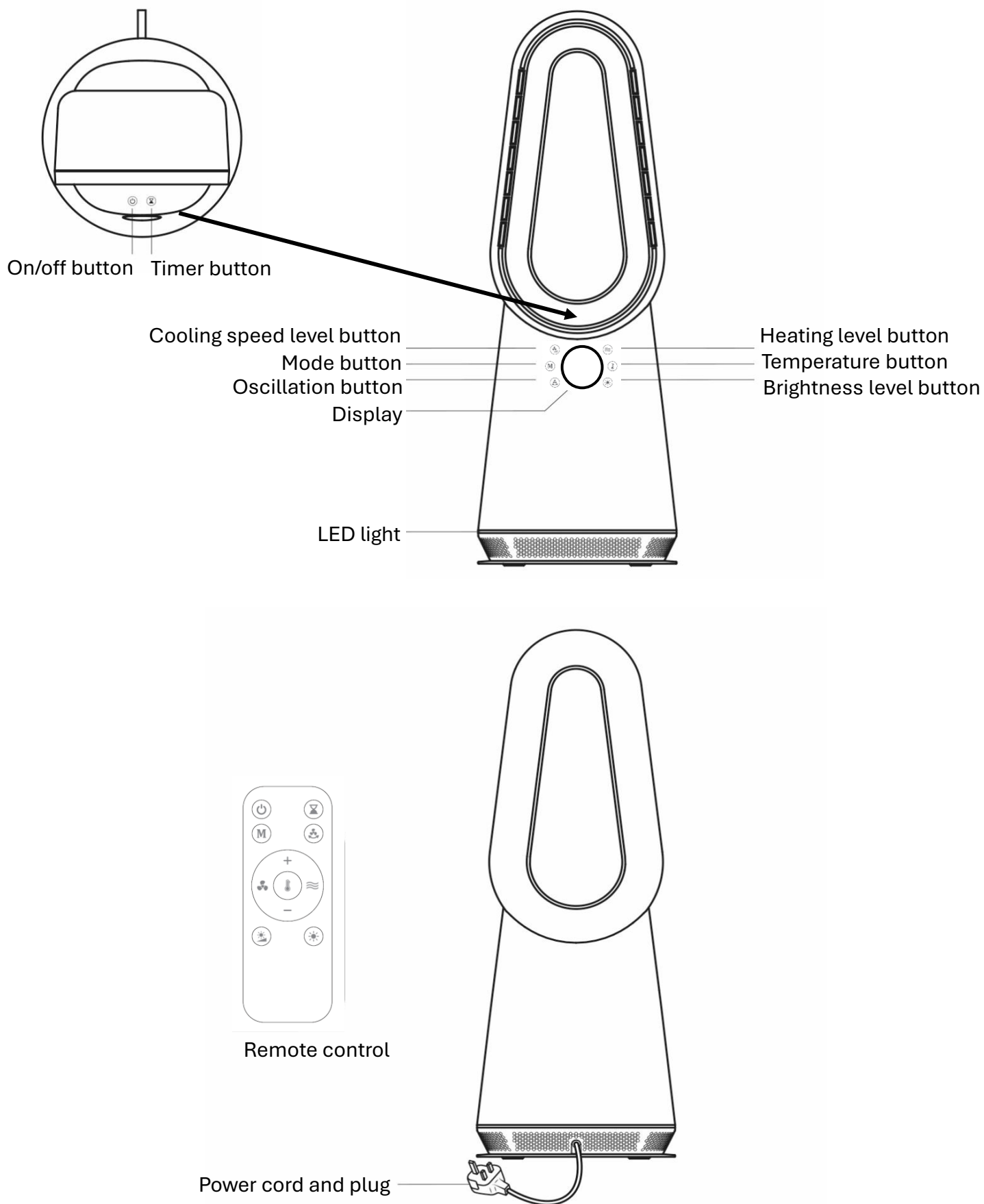

## PRODUCT SETUP

Remove all packaging material and all transport bracing from the device.

For a safe and trouble-free running of the device, choose the installation location which meets the following requirements:

- The floor should be firm, flat and horizontal.
- Keep the following minimum clearances from the device housing:
  - 100cm from its lateral side
  - 100cm above
  - 100cm from its rear side
  - 1.5m from its front side.
- Do not place the device in a hot, wet or very humid environment, or near combustible material.
- The socket should be easily accessible so the mains connection cable can be easily disconnected, if necessary.
- Temperature range: from 0 to + 40 °C .
- Humidity (no condensation): 5 - 75%.

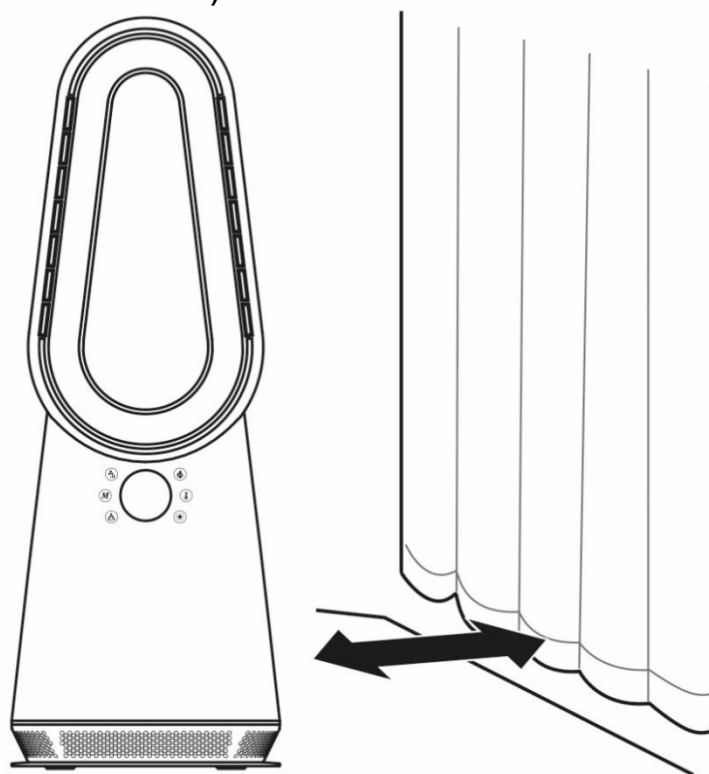

**Note:** Do not place unit near curtains

## CONTROLS AND DISPLAY



### **Power**

Press to turn the machine on and off.



### **Fan Speed**

Press to circulate between the fan speeds of 1 to 9.



### **Timer**

When the power is on, you can schedule to turn off the fan.

- To set the timer, press the timer button and the display will show 1h. Press it again and it will show 2h.
- Continue to press the timer button until the required time is displayed.
- The time range is 1 to 8 hours. 0h indicates that no timer is set.
- A small dot will flash at the bottom right of the display indicating that the timer is set.

When the appliance is in standby mode, you can schedule to turn on the Heating function.

- To set the timer, press the timer button and the display will show 1h. This indicates that the unit is set to turn on in 1hr. Press it again and it will show 2h.
- Continue to press the timer button until the required time is displayed.
- The time range is 1 to 8 hours. 0h indicates that no timer is set.
- A small dot will flash at the bottom right of the display indicating that the timer is set.

## CONTROLS AND DISPLAY



### Mode

Press to change operating mode.

You can choose from Strong air speed mode, Sleep mode, Natural air speed mode and ECO mode.



### Strong

In strong air mode, the fan switches to the highest level.



### Sleep

Sleep mode reduces the current selected speed by 1 level every 15 minutes. It will then settle at the minimum speed: 1.



### Natural

Natural air speed mode that switches between speed settings 3 - 5 - 7 continuously.



### ECO

ECO mode (available only in heating mode)

- If the room temperature is below 18 °C, the appliance operates at high speed.
- If the room temperature is between 18-22 °C, the appliance operates at low speed.
- If the room temperature is above 22 °C, the appliance operates at the lowest fan speed.



**Note:** ECO mode can only be selected in heating mode. If you change the speed during an active operating mode, the operating mode is deactivated and must be reactivated.



### Oscillation

Press to start and stop oscillation.

## CONTROLS AND DISPLAY



### **Temperature Level**

Press to set your desired temperature. The default temperature is 25°C, and it can be adjusted between 5°C and 35°C.

Heating activates only when the set temperature is higher than the room temperature. The unit switches on automatically when the room drops below the set point and turns off once it's reached, maintaining a constant temperature and minimizing power use.

If the room temperature falls below 0°C, the LED display only shows - - as 0°C cannot be displayed.

The heater starts by emitting heat from the left outlet, then from the right after approximately 20 seconds. This is normal. When switched off during heating mode, it goes into blower mode for approximately 30 seconds to cool the heating element. A countdown is shown on the display.



### **Heat Function/ Heat Speed Level**

Press to switch to heating mode. Press repeatedly to increase the desired heating level (the desired temperature will not change).



### **Brightness Level**

Press to turn on the atmospheric light. Press repeatedly to obtain the desired colour: white, blue, green, red, purple and gradient.

To stop the atmospheric light function, press the button again after the gradient colour.

Press and hold the button for about 3 seconds to adjust the brightness level. Up to 4 brightness levels can be set for each colour.

## REMOTE CONTROL



**Note:** The remote should be used within 4m of the front face of the unit. Remove the insulation sheet before use.

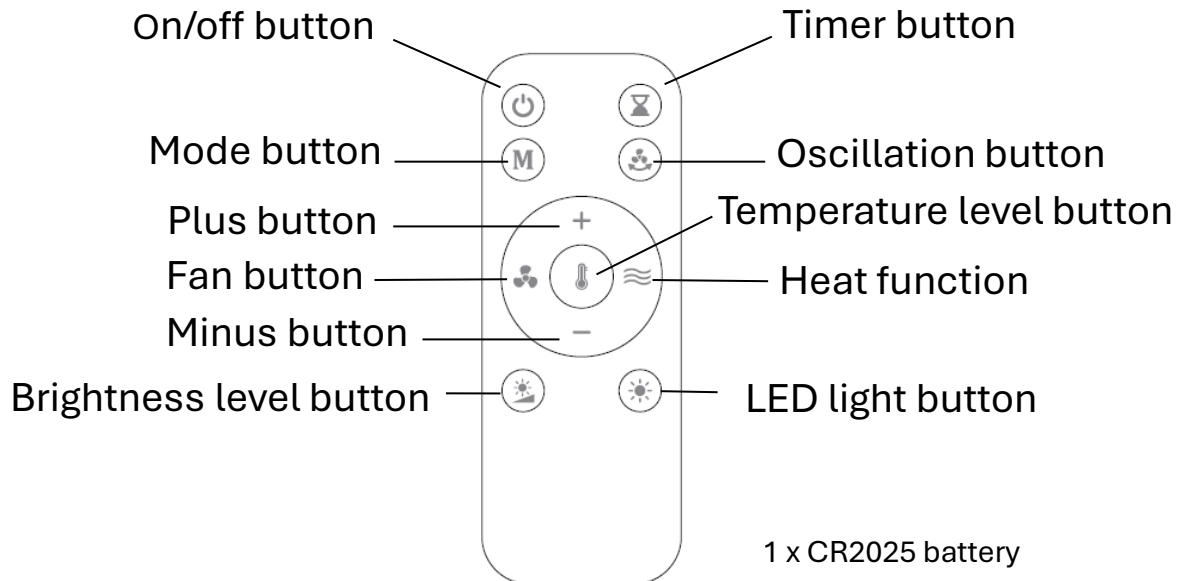

To change the speed, temperature or heating levels, press the fan, temperature level or heat function buttons respectively and then press the '+' or '-' button to adjust.

When the remote control is not in use, put it on the remote-control shelf.

There is a magnet inside to hold the remote control.

Remote control shelf

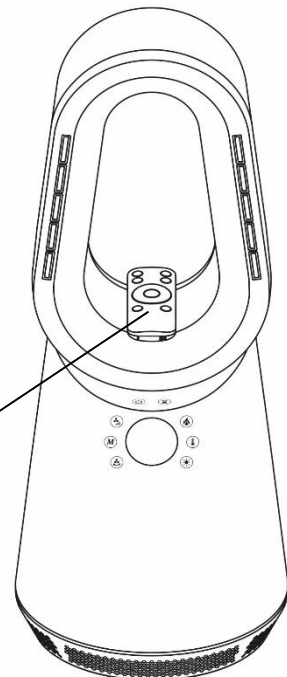

## REMOTE CONTROL

To replace the battery, follow these steps:

1. Hold down the buckle to open the slot.
2. Insert the battery with the correct side facing up.
3. Slide the battery slot back into the remote until it clicks into place.

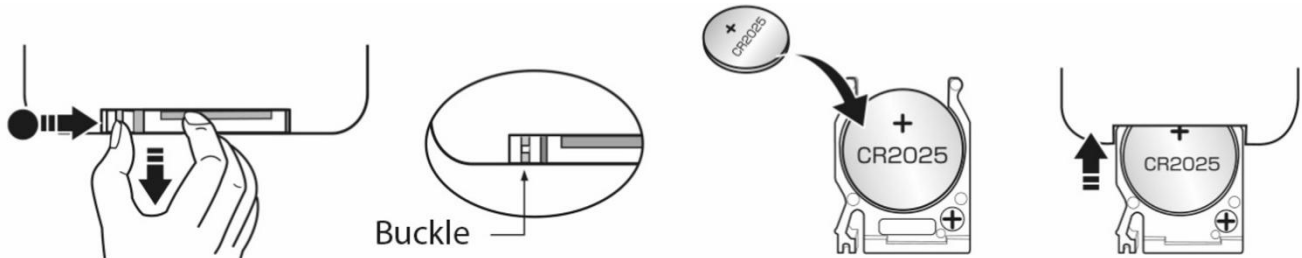

**Note:** Do not charge this battery. If it hasn't been used for a long time, please remove the battery. Keep out of reach of children and, if swallowed, seek medical attention immediately.

Possible remote-control interference:

- This fan may respond to remote controls for other devices.
- If you use the remote control for this unit, other devices may respond.

This is due to the overlapping frequencies of the remote controls. It doesn't indicate quality issues with the product itself. To avoid misuse, keep the remote control away from other electrical devices during operation.

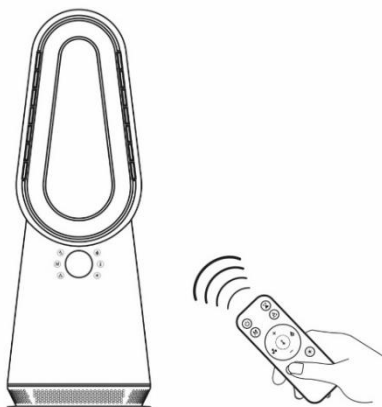

Direct the remote towards the display to maximise the remote-control signal.



## CLEANING AND MAINTENANCE



**Note:** This model should only require minimal maintenance. Do not try to fix it yourself. If service is needed, contact a qualified technician.

- Ensure the unit is unplugged before assembly and before cleaning.
- During maintenance, do not soak or splash water on the unit. Getting the unit wet will damage it.
- Do not use gasoline, alcohol, bleach or metal objects to wipe the fan surface. This can cause the surface to discolour and deteriorate.
- To ensure adequate air circulation to the motor, keep vents at the rear free of dust. Do not disassemble the fan to remove dust.
- Do not use any abrasive detergent or solvents to avoid scratching the surface.
- Do not allow water or any other liquid into the motor housing or interior parts.

### Unit Surface

- Gently wipe the unit's surface with a soft dry cloth.
- If the surface is dirty, the debris can be diluted with neutral detergent and then wiped with a soft cloth.

### Air Inlet and Outlet

- Use a soft brush or vacuum cleaner to remove dust at the air inlet and outlet.
- Too much dust can reduce effectiveness. To maintain the fan, clean it when only a minimal amount of dust has accumulated.

### Storage

- Avoid places with vibration and electrical appliances with cooling/heating function.
- Avoid placing it in direct sunlight, high temperatures and humidity.
- Keep out of the reach of children.

## PROBLEM SOLVING

Unit doesn't switch on	<ul style="list-style-type: none"> <li>• Check the appliance is plugged in.</li> <li>• Check the socket is switched on.</li> <li>• Check another appliance in the socket.</li> <li>• Unplug and check for any obvious signs of damage to the cord or plug.</li> <li>• If recently used, allow to cool for 1 hour, then try again.</li> <li>• Check and remove any object on or adjacent to the appliance.</li> <li>• Ensure your heater is placed on a flat and even surface.</li> <li>• Ensure that your circuit breaker or fuse is working properly</li> <li>• Make sure thermostat is set to a higher temperature than the ambient temperature</li> </ul>
Unit makes a rattling sound	<ul style="list-style-type: none"> <li>• Check there is nothing in contact with the appliance.</li> <li>• Check the appliance is on a level surface.</li> </ul>
Remote doesn't work	<ul style="list-style-type: none"> <li>• The batteries may need replacing.</li> <li>• The remote is being used more than 5m away from the product.</li> </ul>
Unit makes a grinding sound	<ul style="list-style-type: none"> <li>• Immediately switch off and contact Customer Services.</li> </ul>
Air coming out is dusty	<ul style="list-style-type: none"> <li>• Ensure the appliance is unplugged and set to OFF.</li> <li>• Using a vacuum and crevice brush, gently vacuum the front grille.</li> </ul>

## PROBLEM SOLVING

### ERROR CODE

CODE	PROBLEM	POSSIBLE REASON
E1	Low Voltage Protection	<ul style="list-style-type: none"> <li>Induced by voltage too low</li> <li>220V fan connected to 110V voltage</li> </ul>
E2	High Voltage Protection	<ul style="list-style-type: none"> <li>Induced by voltage too high</li> </ul>
E3	Blocked Rotor	<ul style="list-style-type: none"> <li>Poor connection between rotor terminal block and electronic board</li> <li>Circuit driver, power component (MOSFET) or other components damaged by outer forces, Electronic board parameter error</li> </ul>
E4	Hardware Overcurrent	<ul style="list-style-type: none"> <li>Short circuit of fan rotor or inner rotor</li> <li>Driver error or power component (MOSFET) error</li> </ul>
E5	Software Overcurrent	<ul style="list-style-type: none"> <li>Current sampling circuit error</li> </ul>
E6	Motor Malfunction	<ul style="list-style-type: none"> <li>Rotor disconnection</li> <li>Poor connection between rotor and terminal block</li> <li>Driving error of driver</li> </ul>
E7	Communication Error	<ul style="list-style-type: none"> <li>Poor communication between display board and mother board, poor cable connection, PCB malfunction</li> </ul>

## PROBLEM SOLVING

### ERROR CODE

CODE	PROBLEM	POSSIBLE REASON
E8	Machine Tilting	<ul style="list-style-type: none"><li>Machine placed at an angle of <math>\geq 30</math> degrees against the surface</li></ul>
E9	Temp.sensor malfunction	<ul style="list-style-type: none"><li>Temperature-sensor probe poor connection</li></ul>



**Note:** If error persists, contact Customer Service. Do not take the unit apart or attempt to fix it yourself.

## IMPORTANT!

### KEEP GRILLE CLEAN

Vacuum the grille at least once every 3 months.

The fan may require more frequent vacuuming if in a dusty environment.

Ensure that the unit is unplugged before cleaning.

**3**  
**MONTHS**

### RECYCLING

Legislation in some localities mandates that e-waste (anything with a plug, battery or cord) is disposed of through controlled recycling facilities and must not be disposed of in general household waste. For more information about recycling of electrical and battery operated appliances, please contact your local council or your local household waste disposal service.

# CUSTOMER SERVICE AND WARRANTY

**Spectrum Brands Australia Pty Ltd**

Locked Bag 3004 Braeside  
Victoria 3195 Australia

**Spectrum Brands New Zealand Ltd**

PO Box 9817 Newmarket  
Auckland 1149 New Zealand

**Customer Service in Australia**

Toll Free: 1800 623 118  
Email: [consumer.enquiry@russellhobbs.com.au](mailto:consumer.enquiry@russellhobbs.com.au)  
Website: [www.spectrumbrands.com.au](http://www.spectrumbrands.com.au)

**Customer Service in New Zealand**

Toll Free: 0800 736 776  
Email: [info@russellhobbs.co.nz](mailto:info@russellhobbs.co.nz)  
Website: [www.spectrumbrands.co.nz](http://www.spectrumbrands.co.nz)

## **Spectrum Brands Australia Pty Ltd and Spectrum Brands New Zealand Ltd Warranty Against Defects**

In this warranty:

**Australian Consumer Law** means the Australian consumer law set out in Schedule 2 to the Competition and Consumer Act 2010;

**CGA** means the New Zealand Consumer Guarantees Act 1993;

**Goods** means the product or equipment which was accompanied by this warranty and purchased in Australia or New Zealand, as the case may be;

**Manufacturer, We or us** means:

1. for Goods purchased in Australia, Spectrum Brands Australia Pty Ltd ABN, 78 007 070 573; or
2. for Goods purchased in New Zealand, Spectrum Brands New Zealand Ltd, as the case may be, contact details as set out at the end of this warranty;

**Supplier** means the authorized distributor or retailer of the Goods that sold you the Goods in Australia or in New Zealand; and

**You** means you, the original end-user purchaser of the Goods.

1. Our goods come with guarantees that cannot be excluded under the Australian Consumer Law, or the CGA. You are entitled to a replacement or refund for a major failure and compensation for any other reasonably foreseeable loss or damage. You are also entitled to have the goods repaired or replaced if the goods fail to be of acceptable quality and the failure does not amount to a major failure.
2. The benefits provided by this Warranty are in addition to all other rights and remedies in respect of the Goods which the consumer has under either the Australian Consumer Law or the CGA. The original purchaser of the Goods is provided with the following Warranty subject to the Warranty Conditions:
3. We warrant the Goods for all parts defective in workmanship or materials for a period of 2 years from the date of purchase (Warranty Period).

If the Goods prove defective within the Warranty Period by reason of improper workmanship or material, we may, at our own discretion, repair or replace the Goods without charge.

# WARRANTY CONDITIONS

1. The Goods must be used in accordance with the manufacturer's instructions. This Warranty does not apply should the defect in or failure of the Goods be attributable to misuse, abuse, accident or non-observance of manufacturer's instructions on the part of the user. As far as the law permits, the manufacturer does not accept liability for any direct or consequential loss, damage or other expense caused by or arising out of any failure to use the Goods in accordance with the manufacturer's instructions.
2. Exhaustible components (such as batteries, filters and brushes) of the Goods are included under this Warranty only where there is a defect in workmanship or materials used.
3. The warranty granted under clause 3 is limited to repair or replacement only.
4. Any parts of the Goods replaced during repairs or any product replaced remain the property of the manufacturer. In the event of the Goods being replaced during the Warranty Period, the warranty on the replacement Goods will expire on the same date as for the Warranty Period on the original Goods which are replaced.
5. In order to claim under the warranty granted under clause 3 you must:
  - a) Retain this warranty with your receipt/proof of purchase; and
  - b) Return the Goods to us at the relevant address or to the Supplier by prepaid freight within the Warranty Period accompanied with (i) the legible and unmodified original proof of purchase, which clearly indicates the name and address of the Supplier, the date and place of purchase, the product name or other product serial number and (ii) this warranty.
6. This warranty is immediately void if:
  - a) Any serial number or appliance plate is removed or defaced;
  - b) The Goods have been serviced or otherwise repaired by a person not authorised to do so by us or where non approved replaced parts are used.
7. The Goods are designed for domestic use only. The Goods must be connected to the electrical voltage requirements as specified in the ratings label located on the Goods.
8. This warranty does not cover the cost of claiming under the warranty or transport of the Goods to and from the Supplier or us.
9. This warranty is only valid and enforceable in Australia against Spectrum Brands Australia Pty Ltd and in New Zealand against Spectrum Brands New Zealand Ltd.

Contact us or the Supplier for further details.

## REGISTER YOUR PRODUCT ONLINE

Registration of your product is for marketing purposes only, not warranty registration.

If you live in Australia, please visit: <https://au.russellhobbs.com/product-registration>

If you live in New Zealand, please visit: <https://www.russellhobbs.co.nz/product-registration>

Registration entitles you to receive these benefits: Product information; Hints and tips; Recipes and news; Information on special price offers and promotions.

Please retain your receipt as proof of purchase for any warranty claims.

Any questions? Please contact Customer Service for advice.

## NOTES

Model number	RHCBLDL3IN1B-AU
220-240V~ 50-60Hz	
Rated power	2000W
Cooling mode power	28W

