

REMINGTON®

EST. NEW YORK 1937



SENSICUT™ Rotary Shaver RC5390AU

www.remington-products.com.au
www.remington.co.nz

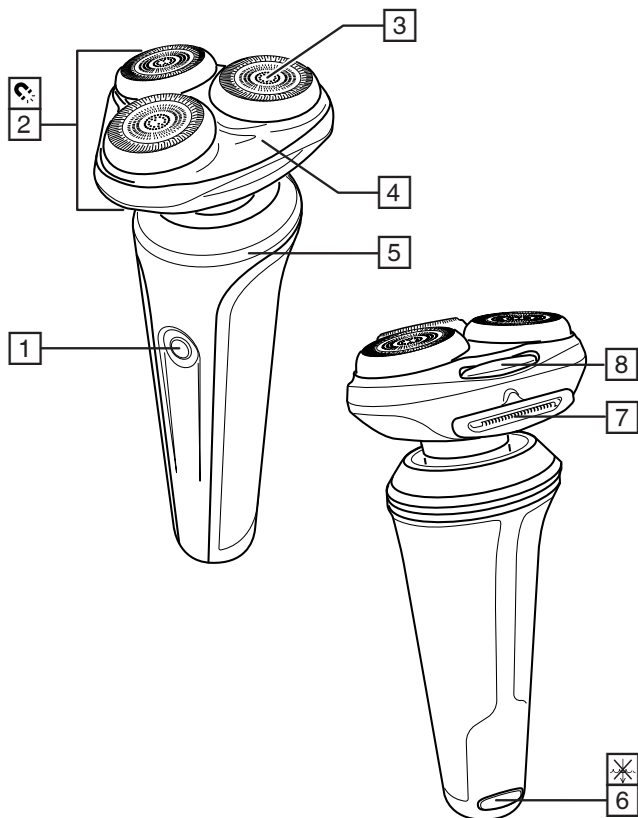

Before First Use



Read the instructions and retain for future reference

Intended Use



Household use only



Suitable for use in bath or shower

Important Safeguards

- Use this appliance only for its intended use as described in this manual.
- This appliance is not intended for use by persons (including children) with reduced physical, sensory or mental capabilities, or lack of experience and knowledge, unless they have been given supervision or instruction concerning use of the appliance by a person responsible for their safety.
- Children shall not play with the appliance. Cleaning and user maintenance shall not be made by children without supervision.
- Keep the appliance and cable out of reach of children.
- Always check the appliance before you use it.
- Do not use the appliance if it is damaged, as this may cause injury.
- The battery is a type Li-Ion, 750mAh.
- The normal temperature range for charging the battery is from 0°C to 45°C.
- Do not expose the appliance or battery

to excessive temperatures. Suitable for use in a bath or shower.

- **WARNING:** Detach the hand-held part from the supply cord before using or cleaning it in water
- Do not use the appliance with a damaged cord.
- Do not use the appliance if it is damaged or malfunctions.
- Do not use attachments other than those we supply.
- This appliance should never be left unattended when plugged into a power outlet, except when charging.
- Keep the power plug and cord away from heated surfaces.
- Do not plug or unplug the appliance with wet hands.
- Do not twist or kink the cable, or wrap it round the appliance.
- This appliance is not intended for commercial or salon use.
- When charging, you must use an external supply unit with an output terminal of 5V & 1A (the measured maximum output power is less than 15W) and meets the requirements of IEC 60335-1 standard.
-

Specification

Charge Type	USB-C
Charge Time (min)	60
Run time (min)	60
IP	IPX7*

* Close and latch the USB-C port. Only open the port when you charge the unit.

Warning Symbol Glossary

✱	Do not fully immerse in water
---	-------------------------------

Parts List

1	Power/Function Button	
2	Pivoting head and cutter assembly	
3	Individual flexing heads	
4	Hairpocket	
5	LED Ring	
6	USB-C port	✱
7	Pop out Trimmer	
8	*Pop out Trimmer Button	
Not Shown		
9	Travel case	
10	Head guard	
11	USB Cable	
12	Cleaning brush	

*Note - Always switch off the appliance when pushing the Pop out Trimmer back into the Head and Cutter Assembly.

Charging

When the battery charges, the LED ring flashes clockwise. When the battery is fully charged, briefly illuminates solid, then switches off.

To preserve the life of your batteries, let the appliance run flat every 6 months then fully charge.

Quick Charge

The appliance has a 5 minute Quick Charge Feature that will provide enough charge for 1 shave lasting 3 minutes.

Instructions for Use - Shaving

- Switch the appliance:

1	Power/Function Button	
---	-----------------------	--

- Stretch the skin with your free hand so the hairs stand upright.
- Only apply light pressure on the shaving head while shaving (pressing too hard can cause skin irritation).
- Use short, circular strokes.

Instructions for Use - Shaving with Gel

- Follow the same instructions as dry shaving if using shaving gel.

Note - After use with shaving gel, please rinse the head and cutters under warm

water to clean away any excess gel and debris.

SensiSpeed™ Mode

Use the SensiSpeed™ feature on sensitive skin.

To activate SensiSpeed™ mode, once switched on:

Button	Action
Power/Function Button	Press + Hold (3 seconds)

A slower RPM and LED Ring will switch from permanently illuminated to a slow pulse confirming the mode is active.

To De-activate SensiSpeed™ mode:

Button	Action
Power/Function Button	Press + Hold (3 seconds)

Pressure Sensor

The Pressure Sensor feature provides feedback on optimum pressure to use on your skin when shaving. This is shown through the:

5	LED Ring	
---	----------	--

Pressure	LED Ring Colour	LED Ring State
----------	-----------------	----------------

Light	White	Solid
Moderate	Green	Solid
High	Red	Flashing

When the LED ring flashes red, a high-frequency vibration also occurs.

Travel Lock

Ensure the appliance is turned off before activating the Travel Lock:

Button	Action
Power/Function Button	Press + Hold (3 seconds)

If the Power/Function Button is pressed while Travel lock is activated, the 5 LED Ring flashes 3 times

To De-activate Travel Lock

Button	Action
Power/Function Button	Press + Hold (3 seconds)

Tips for Best Results

- Hold the appliance at right angles to the skin so that all three heads are touching the skin with equal pressure.
- Use moderate to slow movements. The use of short circular motions in stubborn areas may obtain a closer shave, especially along the neck and

chin line.

- Do not push hard against the skin in order to avoid skin irritation.

Care and Cleaning

This appliance contains no user serviceable parts. Before cleaning, ensure the appliance is switched off.

- Do not use abrasives or brushes to clean components.
- Do not place parts in boiling liquids.

Do not fully immerse in liquid without the latch closed. Only open the port when you charge the unit and securely close when charging is complete.

6	USB-C port
----------	------------

Remove, rinse and dry:

2	*Pivoting head and cutter assembly
3	Individual flexing heads
4	Hairpocket

*Note - The pivoting head and cutter assembly use magnets to attach and remove.

Battery Removal

This appliance contains batteries that are non-replaceable. When the battery is at the end of its life or leaking, the appliance and battery must be properly disposed of at an official recycling point.

We strongly recommend that a

professional removes the rechargeable battery. Parts of the shaver case, and tools have sharp edges and may cause injury if not handled correctly.

- Be aware of the risk of terminals of the battery being short-circuited by metal objects.
- The rechargeable battery must be removed from the appliance before it is scrapped.
- Disconnect the charging USB cable before removing the battery.
- Remove the shaver head.
- Use a small flat screwdriver to pry away the Bottom Cover from unit bottom.
- Unscrew (2s) screws from the unit bottom.
- Hold the handle, and carefully push the unit bottom, and take the internal assembly out.
- Unscrew (4s) screws from the internal assembly.
- Take away the internal assembly cover and expose the printed circuit board.
- Pry the printed circuit board out from internal housing.
- Expose the battery and cut the connections on battery ends.
- Used batteries must be removed from the appliance and disposed of at an appropriate official recycling/ collection point.
- Do not attempt to operate the shaver once you have opened it.
- Dispose of the battery safely.

Disposal & Recycling

Legislation in some localities mandates that e-waste (anything with a plug, battery or cord) is disposed of through controlled recycling facilities and must not be disposed of in general household waste. For more information about recycling of electrical and battery operated appliances, please contact your local council or your local household waste disposal service.

Warranty against defects

Spectrum Brands Australia Pty Ltd and Spectrum Brands New Zealand Limited

In this warranty:

Australian Consumer Law means the Australian consumer law set out in Schedule 2 to the Competition and Consumer Act 2010;

CGA means the New Zealand Consumer Guarantees Act 1993;

Goods means the product or equipment which was accompanied by this warranty and purchased in Australia or New Zealand, as the case may be;

Manufacturer, We or us means:

1. for Goods purchased in Australia, Spectrum Brands Australia Pty Ltd ACN, 007 070 573; or
2. for Goods purchased in New Zealand, Spectrum Brands New Zealand Limited, as the case may be, contact details as set out at the end of this warranty;

Supplier means the authorised distributor or retailer of the Goods that sold you the Goods

in Australia or in New Zealand; and

You means you, the original end-user purchaser of the Goods.

1. Our goods come with guarantees that cannot be excluded under the Australian Consumer Law, or the CGA. You are entitled to a replacement or refund for a major failure and compensation for any other reasonably foreseeable loss or damage. You are also entitled to have the goods repaired or replaced if the goods fail to be of acceptable quality and the failure does not amount to a major failure.
2. The benefits provided by this Warranty are in addition to all other rights and remedies in respect of the Goods which the consumer has under either the Australian Consumer Law or the CGA. The original purchaser of the Goods is provided with the following Warranty subject to the Warranty Conditions:
3. We warrant the Goods for all parts defective in workmanship or materials for the period of three (3) years from the date of purchase (**Warranty Period**). If the Goods prove defective within the Warranty Period by reason of improper workmanship or material, we may, at our own discretion, repair or

replace the Goods without charge.

Warranty Conditions

4. The Goods must be used in accordance with the manufacturer's instructions. This Warranty does not apply should the defect in or failure of the Goods be attributable to misuse, abuse, accident or non-observance of manufacturer's instructions on the part of the user. As far as the law permits, the manufacturer does not accept liability for any direct or consequential loss, damage or other expense caused by or arising out of any failure to use the Goods in accordance with the manufacturer's instructions.
5. Consumable parts (such as shaver heads, cutters and foils) of the Goods are included under this Warranty only where there is a defect in workmanship or materials used.
6. The warranty granted under clause 3 is limited to repair or replacement only.
7. Any parts of the Goods replaced during repairs or any product replaced remain the property of the manufacturer. In the event of the Goods being replaced during the Warranty Period, the warranty on the replacement Goods will expire on the same date as for the Warranty Period on the original Goods which are replaced.
8. In order to claim under the warranty granted under clause 3 you must:
 - (a) Retain this warranty with your receipt/proof of purchase; and
 - (b) Return the Goods to us at the relevant address below or to the Supplier by prepaid freight within the Warranty Period accompanied with (i) the legible and unmodified original proof of purchase, which clearly indicates the name and address of the Supplier, the date and place of purchase, the product name or other product serial number and (ii) this warranty.
9. This warranty is immediately void if:
 - (a) Any serial number or appliance plate is removed or defaced;
 - (b) The Goods have been serviced or otherwise repaired by a person not authorised to do so by us or where non approved replaced parts are used.
10. The Goods are designed for domestic use only. A limited 90-day Warranty applies to any industrial or commercial use of the Goods. The Goods must be connected to the electrical voltage requirements as specified in the ratings label located on the Goods.
11. This warranty does not cover the cost of claiming under the warranty or transport of the Goods to and from the Supplier or us.
12. This warranty is only valid and enforceable in Australia against Spectrum Brands Australia Pty Ltd and

in New Zealand against Spectrum
Brands New Zealand Limited.

Service Centre

AU

Spectrum Brands Australia Pty Ltd
Locked Bag 3004
Braeside, VIC 3195
AUSTRALIA
Customer service in Australia:
1800 623 118
E-mail: [consumer.enquiry@remington-
products.com.au](mailto:consumer.enquiry@remington-products.com.au)
Website: [www.remington-products.
com.au](http://www.remington-products.com.au)

NZ

Spectrum Brands New Zealand Limited
PO Box 9817
Newmarket, Auckland 1149
NEW ZEALAND
Customer service in New Zealand:
0800 736 776
E-mail: info@remington.co.nz
Website: www.remington.co.nz

Ref. No. RC5390AU**Type No. R39A**

26/AU/ RC5390AU

T22-0005739-A

Version 01 /26

Remington® is a Registered Trade Mark
of Spectrum Brands, Inc., or one of its
subsidiaries.

Spectrum Brands Australia Pty Ltd
Locked Bag 3004
Braeside, VIC 3195
AUSTRALIA

Spectrum Brands New Zealand
Limited
PO Box 9817
Newmarket, Auckland 1149
NEW ZEALAND

© 2026 Spectrum Brands, Inc.
