

REMINGTON®

EST. NEW YORK 1937



The Works Beard Trimmer Kit MB905AU

www.remington-products.com.au
www.remington.co.nz

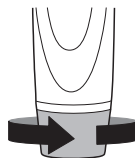
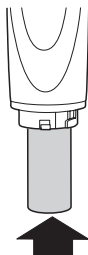
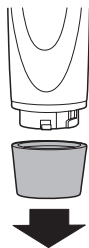
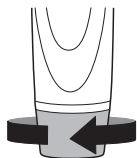
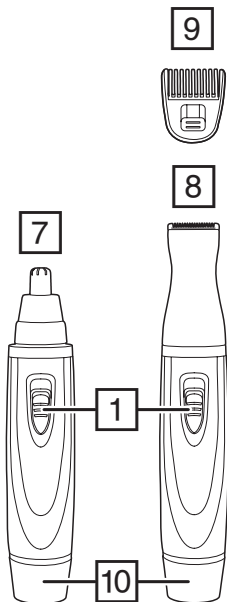
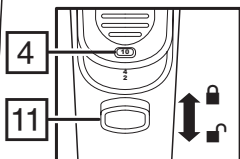
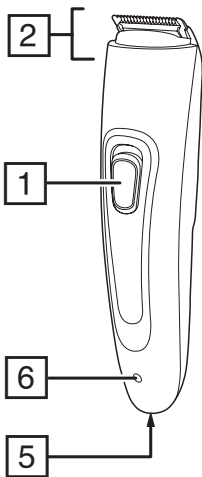
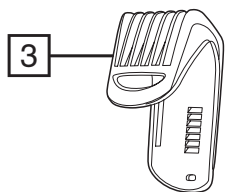

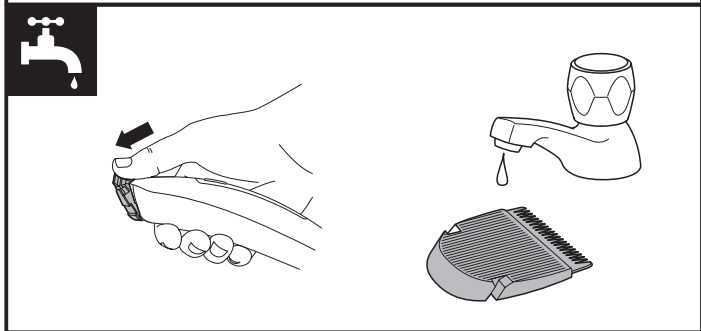
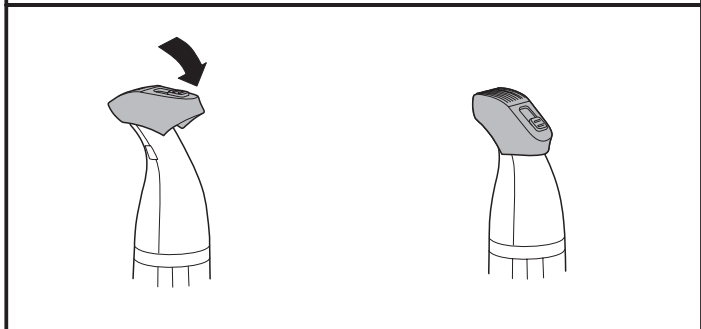
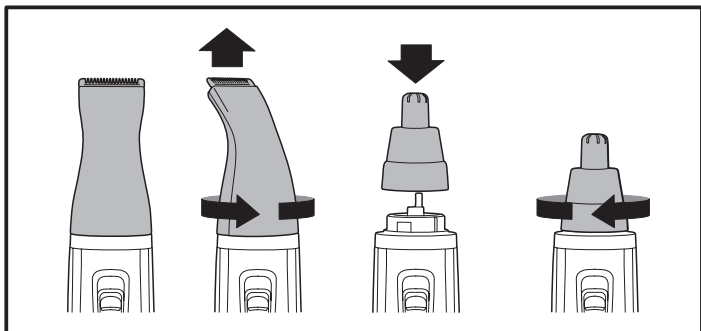

IMPORTANT SAFEGUARDS

When using electrical appliances, basic precautions should always be observed, including the following.

READ ALL INSTRUCTIONS BEFORE USING

- The appliance should never be left unattended when plugged into a power outlet, except when charging the appliance.
- This appliance is not intended for use by persons (including children) with reduced physical, sensory or mental capabilities, or lack of experience and knowledge, unless they have been given supervision or instruction concerning use of the appliance by a person responsible for their safety.
- Children shall not play with the appliance.
- Cleaning and user maintenance shall not be made by children without supervision.
- The battery in the beard trimmer is not replaceable.
- Use and store the product at a temperature between 0°C and 32°C.
- Do not use outdoors or where aerosol (spray) products are being used, or where oxygen is being administered.
- Do not plug or unplug the appliance with wet hands.
- For household use only.
- Do not place in or drop into water or any other liquid.
- Do not use while bathing or in the shower.
- Use this appliance only for its intended use as described in this manual.
- Do not use attachments not recommended by Remington.
- Do not expose the appliance or battery to excessive temperatures;
- **WARNING:** Keep the appliance dry.
- The battery is a type nickel metal hydride battery 1200mAH and must only be charged between 0°C and 40°C.

BATTERY SAFETY

- Remove batteries if the unit is not in use for long periods.
- It is not recommended to use a rechargeable battery as this can result in poor performance
- Do not try to charge non-rechargeable batteries.
- Do not dispose of used batteries in a fire.
- Do not short circuit the battery contacts.
- Used batteries must be removed from the appliance, recycled or disposed of in an environmentally friendly way (see RECYCLING).



This product is not suitable to use in the bath or shower.

SAVE THESE INSTRUCTIONS

PARTS

- | | |
|-----------------------------------|----------------------------|
| 1. On/off switch | 9. Adjustable stubble comb |
| 2. Main blade | 10. Battery compartment |
| 3. Adjustable beard comb 2 – 18mm | 11. Comb lock |
| 4. Length position indicator | Not Shown: |
| 5. Charger connector | • USB charging cable |
| 6. Charging indicator light | • Beard brush |
| 7. Rotary trimmer | • Storage pouch |
| 8. Precision trimmer | |
-

GETTING STARTED

CHARGING YOUR BEARD TRIMMER

- It is recommended to fully charge your appliance before using it for the first time.
- Ensure the product is switched off.
- Connect the product to the USB cable and then to the USB end of the cable to a powered USB port.

CHARGING INDICATOR LIGHTS

When charging, the charge indicator will come on. When fully charged the indicator will stay on.

- Run time from fully charged is up to 45 mins.
 - Charge time from empty is 16 hours.
 - Do not recharge your product after each use as this will shorten the life of the battery.
 - Note: To preserve the life of your batteries, let them run out every 6 months then fully charge.
-

INSTRUCTIONS FOR USE

BEFORE YOU BEGIN

- Comb facial hair with a fine comb before you start trimming.

ATTACHING AND REMOVING THE BEARD COMB

- Make sure that the comb lock is in the down (unlocked) position.
- Slide the comb down the grooves until it clicks into place.

- To remove, make sure that the comb lock is in the down (unlocked) position then slide the comb off the trimmer.

ADJUSTING THE TRIM LENGTH

- The beard comb can be adjusted to give you 9 different trim lengths.
- To adjust, make sure the comb lock is in the down (unlocked) position and slide the comb up or down until the desired length is in the length position indicator window.
- Lock the setting by sliding the comb lock button up to the locked position.
- Use the beard trimmer without the adjustable comb for trimming hair close to the skin. This will trim hair to 1mm, holding the blades perpendicular to the skin will trim hair to 0.4mm.

TO THIN AND TAPER THE BEARD/MOUSTACHE

- Fit the adjustable beard comb.
- Turn the unit on.
- Place the flat top of the trimmer comb against the skin.
- Slowly slide through the hair. Repeat from different directions as necessary.
- If hair builds up in the trimmer comb during the trimming process, switch the unit off, pull off the comb and brush the hair off.

TO DEFINE THE BEARD/MOUSTACHE LINE

- Remove the adjustable beard comb.
- Start with edge of beard/moustache line and gently lower the trimmer blade onto your skin.
- Use motions towards edge of beard/moustache line to trim to desired locations in facial area and away from beard in neck area.

TRIMMING EDGE OF SIDEBURNS

- Remove the adjustable beard comb.
- Start with edge of sideburn and with the trimmer blades resting lightly against your skin, use motions towards edge of sideburn line to trim the desired locations in facial area.

TRIMMING THE NAPE OF YOUR NECK

- Note: You will need a hand mirror for this operation if performing it alone.
- Remove the adjustable beard comb.
- Use your fingers to lift the hair at the base of your head up off the neck. Your index finger should be covering the roots of the hairs you are lifting to prevent accidental removal by trimmer.
- Using your other hand, hold the trimmer to the base of your neck with the cutting unit facing up and move the trimmer up the length of the neck until it touches your finger, covering the hair roots at the base of your head.
- Be sure to move the unit slowly when performing this operation and to keep the hair roots at the base of your head out of the way of the trimmer.

CARE FOR YOUR BEARD TRIMMER

- Your beard trimmer is fitted with high quality blades.
- To ensure long lasting performance of your beard trimmer, clean the blades and body regularly.
- Always keep the attachment guide comb on the trimmer blade.

AFTER EACH USE

- Ensure the appliance is switched off and unplugged from the charging source before cleaning.
- Brush the accumulated hair from the blades and body of your beard trimmer. Do not submerge it in water.
- To clean unit, wipe with a damp cloth and dry immediately.
- Place a few drops of cutter or sewing machine oil onto the blades. Wipe off excess oil.

EVERY SIX MONTHS

- Hold the clipper in one hand so that the blades are at the top, place your thumb underneath the blades and press upwards, the blade set will detach from the device.
- Brush the accumulated hair from the blades.
- To replace the blade, make sure the blade is aligned and the grooves on the blade cartridge match up with slots in the housings.
- Push the blade into the housing until it snaps into place.

BATTERY DISPOSAL

Note: The beard trimmer battery is not intended to be removed or replaced under normal use. The only time the battery should be removed or the unit opened or disassembled, is at the end of the product's useful life before it is discarded.

- The beard trimmer contains a nickel metal hydride battery. Once the shaver has reached the end of its life, to ensure proper disposal of the product, please take the appliance to a recycling centre, where the internal rechargeable battery should be removed by a professional and recycled separately.
- For more information about recycling of electrical and battery operated appliances, please contact your local council office or your household waste disposal service.

Caution: Do not put in the fire or mutilate your batteries when disposing as they may burst and release toxic materials. Do not short circuit as it may cause burns.

We suggest you use local waste management centres to recycle this product at end of life.

PRECISION TRIMMER, AND NOSE AND EAR TRIMMER

INSERTING BATTERIES

- Both trimmers require 1 'AA' alkaline battery (first one included).
- Ensure the product is switched off.
- To open the battery compartment, turn the base of the unit approximately 1cm counter-clockwise and pull it off.
- Insert the battery into the unit, positive end first.
- Replace the base and turn it 1cm clockwise to lock it into place.

Note: Your trimmer will not work if the batteries are inserted incorrectly.

INSTRUCTIONS FOR USE

Note: Do not apply excessive pressure as this damages the trimmer head and may cause skin injury.

TO REMOVE HAIR FROM NOSE

- Select the nose and ear trimmer.
- Insert it gently into the nostril.
- Gently move it in and out of your nostril and at the same time rotate it.
- Avoid inserting the cutting unit more than 6mm into your nostril.

TO TRIM SIDEBURNS

- Select the precision trimmer.
- Gently guide the cutting unit to your sideburns holding the unit horizontally at a 90 degree angle to the sideburns.
- Trim the sideburns moving the trimmer slowly and carefully, to ensure that you do not accidentally cut hairs that you do not intend to trim.
- Note: It is not recommended that you use the trimmer to define or trim the eyebrows.

TO REMOVE HAIR FROM EAR

- Select the nose and ear trimmer.
 - Insert the cutting unit gently into the outer ear canal opening.
 - Gently rotate the trimmer in a circular motion.
 - Avoid inserting the cutting unit more than 6mm into your ear canal.
-

CARE FOR YOUR TRIMMER

- Care for your product to ensure a long lasting performance. We recommend that you clean it after each use.
- For best results, keep trimmer running while rinsing it under the tap.
- Dry off excess water.
- Do not submerge in water as damage will occur.

TROUBLESHOOTING

- The trimmer is not running but has battery power left:
- If the trimmer is not running it may need cleaning; look for and remove any dried debris from the cutting blades.

AFTER EACH USE

- Rinse the accumulated hair from the cutters as noted above. Ensure all debris is removed from between the blades and shake off excess water.

BATTERY REMOVAL

- The battery must be removed from the appliance before it is scrapped.
- Rotate the battery compartment cap approximately ¼ turn anti-clockwise then pull off.
- Remove the battery from the battery compartment.
- Place the cap back on the unit opposite to how it came off and rotate clockwise until the cap snaps into place.
- The battery is to be disposed of safely.

DISPOSAL/RECYCLING

Legislation in some localities mandates that e-waste (anything with a plug, battery or cord) is disposed of through controlled recycling facilities and must not be disposed of in general household waste. For more information about recycling of electrical and battery operated appliances, please contact your local council or your local household waste disposal service.

Spectrum Brands Australia Pty Ltd and Spectrum Brands New Zealand Limited

WARRANTY AGAINST DEFECTS

In this warranty:

Australian Consumer Law means the Australian consumer law set out in Schedule 2 to the Competition and Consumer Act 2010;

CGA means the New Zealand Consumer Guarantees Act 1993;

Goods means the product or equipment which was accompanied by this warranty and purchased in Australia or New Zealand, as the case may be;

Manufacturer, We or us means:

1. for Goods purchased in Australia, Spectrum Brands Australia Pty Ltd ACN, 007 070 573; or
2. for Goods purchased in New Zealand, Spectrum Brands New Zealand Limited, as the case may be, contact details as set out at the end of this warranty;

Supplier means the authorised distributor or retailer of the Goods that sold you the Goods in Australia or in New Zealand; and

You means you, the original end-user purchaser of the Goods.

1. Our goods come with guarantees that cannot be excluded under the Australian Consumer Law, or the CGA. You are entitled to a replacement or refund for a major failure and compensation for any other reasonably foreseeable loss or damage. You are also entitled to have the goods repaired or replaced if the goods fail to be of acceptable quality and the failure does not amount to a major failure.
2. The benefits provided by this Warranty are in addition to all other rights and remedies in respect of the Goods which the consumer has under either the Australian Consumer Law or the CGA. The original purchaser of the Goods is provided with the following Warranty subject to the Warranty Conditions:
3. We warrant the Goods for all parts defective in workmanship or materials for the period of three (3) years from the date of purchase (**Warranty Period**). If the Goods prove defective within the Warranty Period by reason of improper workmanship or material, we may, at our own discretion, repair or replace the Goods without charge.

Warranty Conditions

1. The Goods must be used in accordance with the manufacturer's instructions. This Warranty does not apply should the defect in or failure of the Goods be attributable to misuse, abuse, accident or non-observance of manufacturer's instructions on the part of the user. As far as the law permits, the manufacturer does not accept liability for any direct or consequential loss, damage or other expense caused by or arising out of any failure to use the Goods in accordance with the manufacturer's instructions.
2. Consumable parts (such as shaver heads, cutters and foils) of the Goods are included under this Warranty only where there is a defect in workmanship or materials used.
3. The warranty granted under clause 3 is limited to repair or replacement only.
4. Any parts of the Goods replaced during repairs or any product replaced remain the property of the manufacturer. In the event of the Goods being replaced during the Warranty Period, the warranty on the replacement Goods will expire on the same date as for the Warranty Period on the original Goods which are replaced.
5. In order to claim under the warranty granted under clause 3 you must:
 - (a) Retain this warranty with your receipt/proof of purchase; and
 - (b) Return the Goods to us at the relevant address below or to the Supplier by prepaid freight within the Warranty Period accompanied with (i) the legible and unmodified original proof of purchase, which clearly indicates the name and address of the Supplier, the date and place of purchase, the product name or other product serial number and (ii) this warranty.
6. This warranty is immediately void if:
 - (a) Any serial number or appliance plate is removed or defaced;
 - (b) The Goods have been serviced or otherwise repaired by a person not authorised to do so by us or where non approved replaced parts are used.
7. The Goods are designed for domestic use only. A limited 90-day Warranty applies to any industrial or commercial use of the Goods. The Goods must be connected to the electrical voltage requirements as specified in the ratings label located on the Goods.
8. This warranty does not cover the cost of claiming under the warranty or transport of the Goods to and from the Supplier or us.
9. This warranty is only valid and enforceable in Australia against Spectrum Brands Australia Pty Ltd and in New Zealand against Spectrum Brands New Zealand Limited.

Contact us or the Supplier for further details.

Spectrum Brands Australia Pty Ltd

Locked Bag 3004

Braeside, VIC 3195

AUSTRALIA

Customer service in Australia: 1800 623 118

E-mail: consumer.enquiry@remington-products.com.au

Website: www.remington-products.com.au

Spectrum Brands New Zealand Limited

PO Box 9817

Newmarket, Auckland 1149

NEW ZEALAND

Customer service in New Zealand: 0800 736 776

E-mail: info@remington.co.nz

Website: www.remington.co.nz

REMINGTON®
EST. NEW YORK 1937

