

REMINGTON®

Ultimate Series Rotary Shaver



R7 / R8

 www.remington.co.uk

Register online for an EXTRA year guarantee

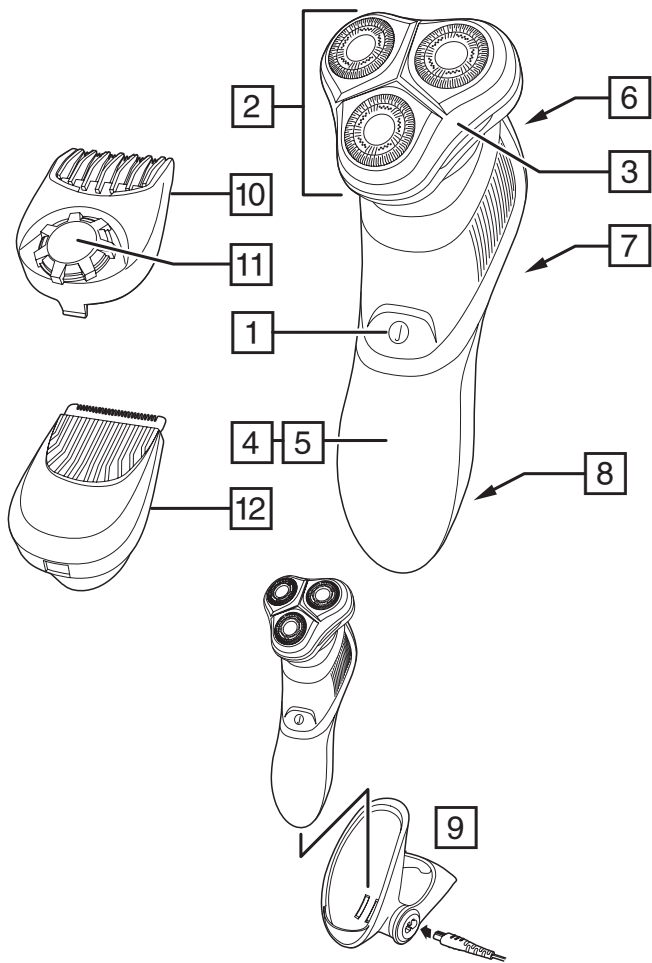

Visit www.remington.co.uk/productregister. You must register within 28 days of purchase.

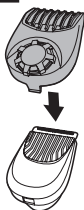
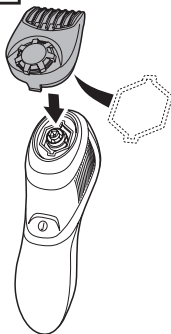
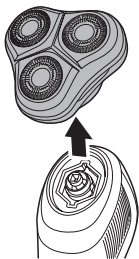
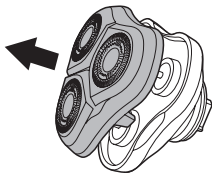

A**B****C****D****E****F**

Thank you for buying your new Remington® product. Please read these instructions carefully and keep them safe. Remove all packaging before use.

IMPORTANT SAFEGUARDS

- This appliance can be used by children aged from 8 years and above and persons with reduced physical, sensory or mental capabilities or lack of experience and knowledge if they have been supervised/instructed and understand the hazards involved. Children shall not play with the appliance. Cleaning and user maintenance shall not be done by children unless they are older than 8 and supervised. Keep the appliance and cable out of reach of children under 8 years.
- Always check the appliance before you use it. Do not use the appliance if it is damaged, as this may cause injury.
- The adaptor contains a transformer. Do not cut off the adaptor to replace it with another plug, as this causes a hazardous situation.
-  The shaver is suitable for cleaning under an open water tap.
-  Suitable for use in a bath or shower.
- **WARNING:** Detach the shaver from the charging adaptor before cleaning it in water.
- Do not use the product with a damaged cord. A replacement can be obtained via our International Service Centres.
- This product should only be used with the charging adaptor supplied.
- Always replace a damaged adaptor with one of the original type.
- Do not use the shaver, charging adaptor, charging stand or any other part if it is damaged, as this may cause injury.
- This appliance should never be left unattended when plugged into a power outlet, except when charging.
- Keep the power plug and cord away from heated surfaces.

- Do not plug or unplug the appliance with wet hands.
- Do not twist or kink the cable, or wrap it round the appliance.
- This appliance is not intended for commercial or salon use.

PARTS

- | | |
|---|---|
| 1. On/off switch | 9. Charging stand |
| 2. Head and cutter assembly | 10. Comb (R8 only) |
| 3. Hair pocket | 11. Comb adjustment dial (R8 only) |
| 4. Charging indicator light and low battery indicator (R7 only) | 12. Beard trimming attachment (R8 only) |
| 5. Fuel gauge (R8 only) | 13. Adaptor (not shown) |
| 6. Pop-up trimmer | 14. Headguard (not shown) |
| 7. Trimmer release button | 15. Cleaning brush (not shown) |
| 8. Charging pins | 16. Storage case (not shown) |
-

GETTING STARTED

Charge the shaver:

Note: This shaver is for cordless use only.

1. Ensure the appliance is turned off.
2. Connect the charging stand to the adaptor and then to the mains.
3. Place the shaver in the charging stand.
4. Charge for at least 24 hours when using for the first time.
 - To preserve the life of your batteries, let them run out every 6 months then recharge for 24 hours.
 - The appliance adapts automatically to a mains voltage between 100V and 240V.

R7

- When the charge is low, the upper LED will illuminate red.
- When charging the lower LED will illuminate green. When fully charged both LEDs will be off.
- Allow 4 hours for a full charge.

R8

- The fuel gauge will display the amount of charge left when the shaver is on. When charging, the LEDs cycle in a rotating pattern. When fully charged all LEDs will come on then turn off.
- Allow 90 minutes for a full charge.

INSTRUCTIONS FOR USE

It is recommended that you use your new shaver daily for up to four weeks to allow time for your beard and skin to become accustomed to the new shaving system.

Shaving

1. Switch the shaver on.
2. Stretch the skin with your free hand so the hairs stand upright.
3. Only apply light pressure on the shaving head while shaving (pressing too hard can damage the heads and make them vulnerable to breakage).
4. Use short, circular strokes.

Shaving with shaving gel

- Follow the same instructions as dry shaving if using shaving gel.
- CAUTION After use with shaving gel, please rinse the head and cutters under warm water to clean away any excess gel and debris.

Trimming

- Push the trimmer button to release the detail trimmer.
- Hold the trimmer at right angles to your skin.
- Place the trimmer at desired trim line for a quick, easy, professional trim.
- To retract the trimmer, push down until it locks into position.

Beard trimmer attachment (R8 only)

To fit the beard trimmer attachment:

1. Switch off your shaver.
 2. Grasp the head and cutter assembly and pull it away from the body of your shaver (Fig A).
 3. If using, snap the comb to the beard trimming attachment (Fig B).
 4. Align the underside of the beard trimmer attachment with the hexagonal recess in the shaver body and click it into place (Fig C).
- Use the trimmer without the comb for trimming hair close to the skin. This will trim hair to 1mm, holding the blades perpendicular to the skin will trim hair to 0.4mm.
 - Adjust the comb setting by rotating the adjustment dial on top of the comb clockwise to increase the cut length or anticlockwise to reduce the cut length. The selected setting is shown on the scale.

TIPS FOR BEST RESULTS

- Use moderate to slow stroking movements. The use of short circular motions in stubborn areas may obtain a closer shave, especially along the neck and chin line.
- DO NOT press hard against the skin in order to avoid damage to the rotary heads.

CARE FOR YOUR SHAVER

To ensure long lasting performance clean after each use.

5. Grasp the head and cutter assembly and pull it away from the body of your shaver (Fig D).
6. Pull the face off the hair pocket (Fig E).
7. Tap out excess hair shavings from the hair pocket (Fig F). Hair clippings can also be washed out of the hair pocket and or shave face by rinsing these under the tap.
8. Once dry, snap the face back onto the hair pocket.
 - The easiest and most hygienic way to clean the appliance is by rinsing the appliance head after use with warm water.
 - Lubricate the teeth of the trimmer every six months with a drop of sewing machine oil.

REMOVING THE RECHARGEABLE BATTERY

We strongly recommend that a professional removes the rechargeable battery. Parts of the shaver case, and tools have sharp edges and may cause injury if not handled correctly.

- The rechargeable battery must be removed from the appliance before it is scrapped.
 - Disconnect the charging adapter before removing the battery.
1. Run the shaver until the motor stops.
 2. Remove the head from the shaver (pull the head up and off).
 3. Using a small screwdriver, pry the 'collar' off the top of the handle.
 4. Using a small screwdriver, pry the front cover from the body.
 5. Remove three screws located on front of shaver.
 6. Using a small screw driver, pry up the newly unsecured inner housing to expose the battery.
 7. Pry the battery free from the circuit board.
- Used batteries must be removed from the appliance and disposed of at an appropriate official recycling/collection point.
 - Do not attempt to operate the shaver once you have opened it.

RECYCLING



To avoid environmental and health problems due to hazardous substances, appliances and rechargeable and non-rechargeable batteries marked with one of these symbols must not be disposed of with unsorted municipal waste. Always dispose of electrical and electronic products and, where applicable, rechargeable and non-rechargeable batteries, at an appropriate official recycling/collection point.

SERVICE AND GUARANTEE



Defects affecting product functionality appearing within the guarantee period will be corrected by replacement or repair at our option provided the product is used and maintained in accordance with the instructions. Your statutory rights are not affected.

To claim an extra 1 year guarantee, register your product online within 28 days of purchase.

Register at: www.remington.co.uk/productregister

Consumables are guaranteed only for their recommended lifecycle. Replacement/spare parts* are excluded and are only covered by a 1 year warranty.

*Examples include, but are not limited to, adaptors, haircare attachments, grooming accessories, etc.

SERVICE CENTRE

United Kingdom

 Tel 0800 212 438 (free call mainland UK)

Spectrum Brands (UK) Ltd

Fir Street, Failsworth, Manchester

M35 0HS, UK

www.remington.co.uk

Ireland

 Tel 142 951 40

Remington Consumer Products,

Unit B12, Ballymount Corporate Park,

Ballymount, Dublin 12

www.ie.remington-europe.com

 **REGISTER ONLINE**

Register online for an EXTRA year guarantee*.

Visit www.remington.co.uk/productregister

*You must register within 28 days of purchase.

Model No. XR1530 / XR1550

18/UK/ XR1530 / XR1550 T22-7000613 Version 11 /18

Remington® is a Registered Trade Mark of Spectrum Brands, Inc., or one of its subsidiaries.
Spectrum Brands (UK) Ltd

Fir Street,

Failsworth,

Manchester

M35 0HS

www.remington.co.uk

© 2018 Spectrum Brands, Inc.